



# RDX Fuel Injector Install

How to install RDX 410cc K-Series fuel injectors

Written By: Hybrid Racing



## Step 1 — RDX Fuel Injector Install



- Use a 10mm socket to remove the two nuts that hold the upper engine cover in place.
  - Remove the engine cover.
- i** If you are installing an aftermarket fuel rail as seen in this guide, you will not be able to re-use the factory engine cover.

## Step 2

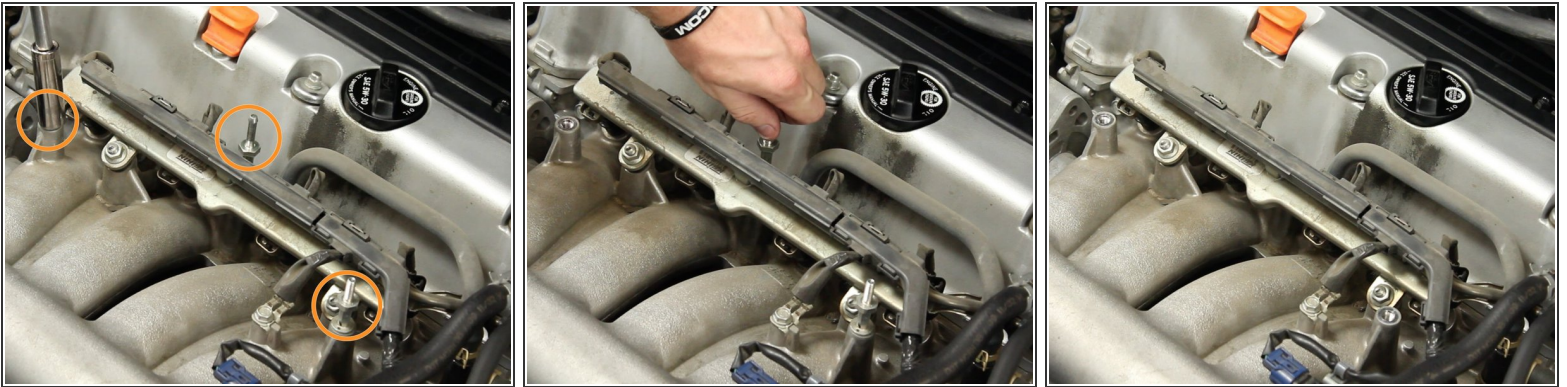

- Remove the upper engine cover mounting studs. (3)

### Step 3

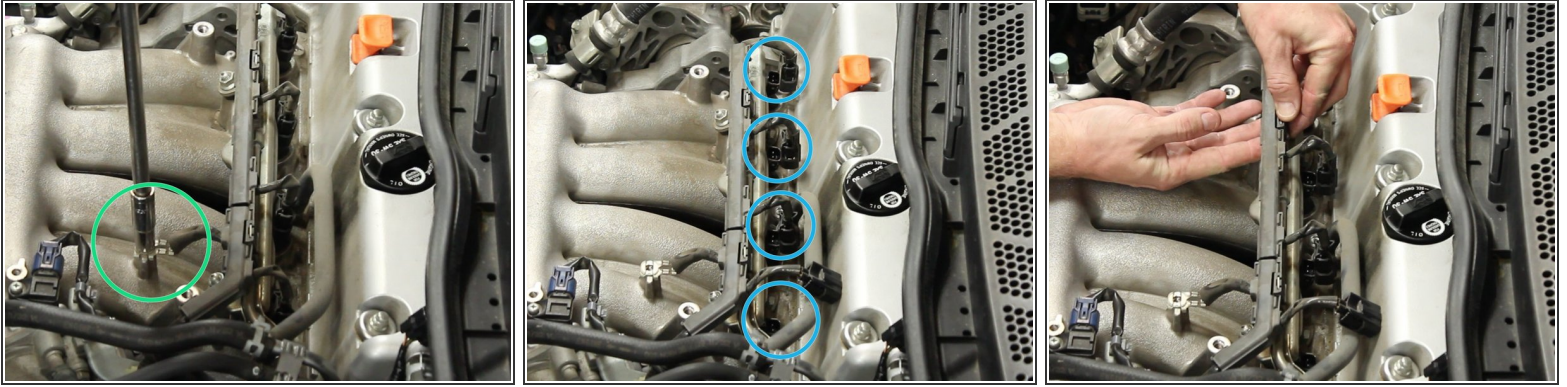

- Remove the upper intake manifold ground.
- Disconnect all of the fuel injectors.
- Un-clip the wire harness from the top of the OEM fuel rail and move it out of the way.

### Step 4



- Using a flat tip screw driver or pick, remove the plastic wire harness cover.
- ⓘ There are many clips that hold the cover together, you may need to use both hands to pry it open as you un-clip it. This item will not be reused.

## Step 5

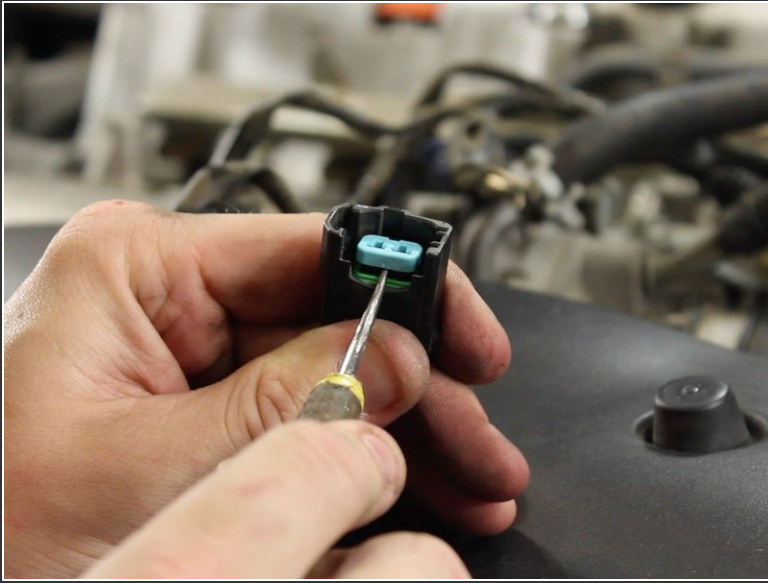

- Using a small flat tip screw driver or pick tool, remove the pin lock inside of the OEM fuel injector connectors. (qty 4)

## Step 6



- Using a small point pick, pry the pin lock upwards while pulling the wire out of the connector.

**⚠ Be sure not to damage or deform the factory pins.**

- ❗ This guide shows the use of the factory pins in the RDX injector connectors. These pins **WILL** work, however they do not lock in place. If you choose to install the RDX injector connector pins (sold separately,) do that now.

## Step 7

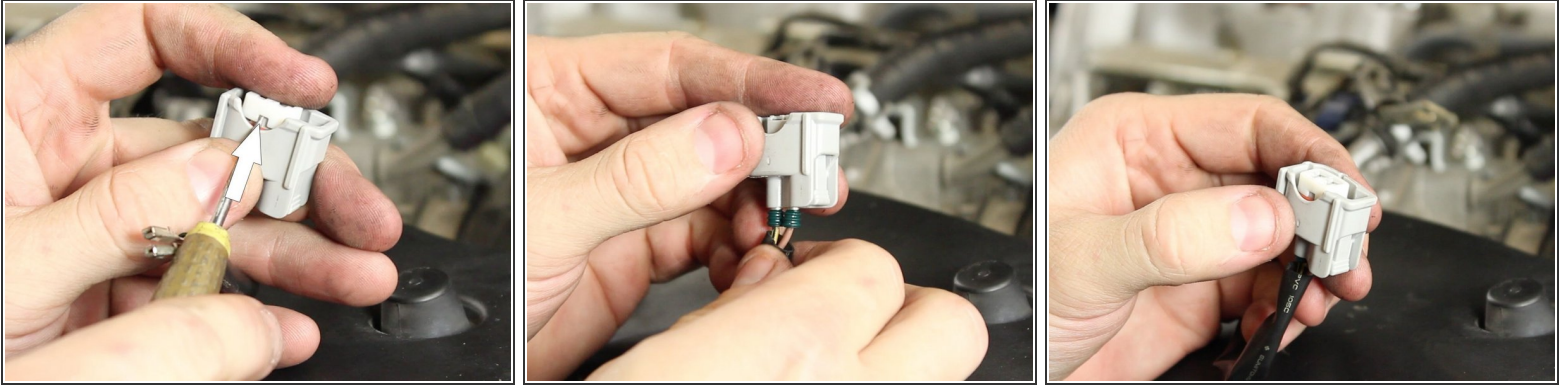

- Insert pins into the new RDX injector clips.
- ☑ Be sure the yellow wire with the black line is on the opposite side of the clipping mechanism as shown in the pictures.
- Snap pin lock down on the clip to lock the pins in place.

## Step 8

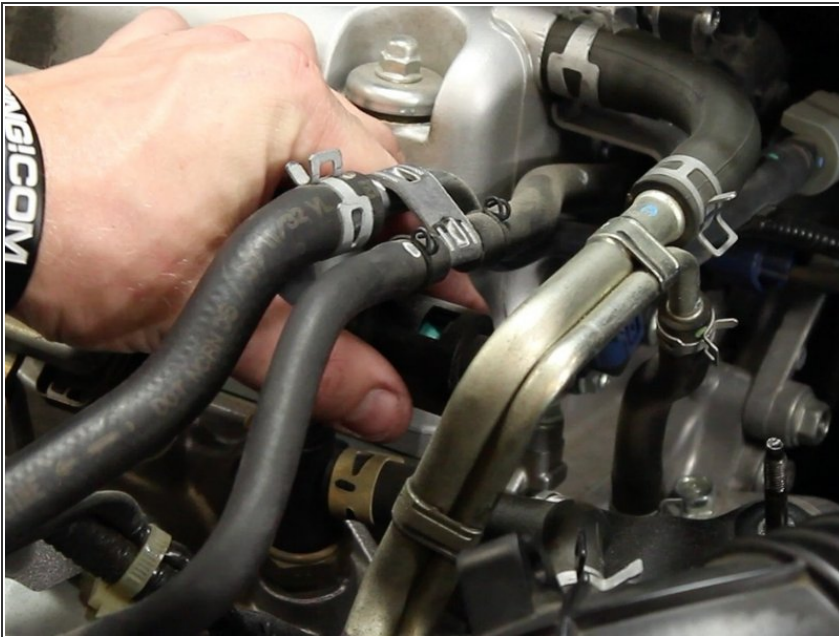

- Remove the quick disconnect fuel fitting cover from the fuel rail connection.
- ⓘ If you are using an aftermarket fuel rail, you will not need to reuse the cover.

## Step 9

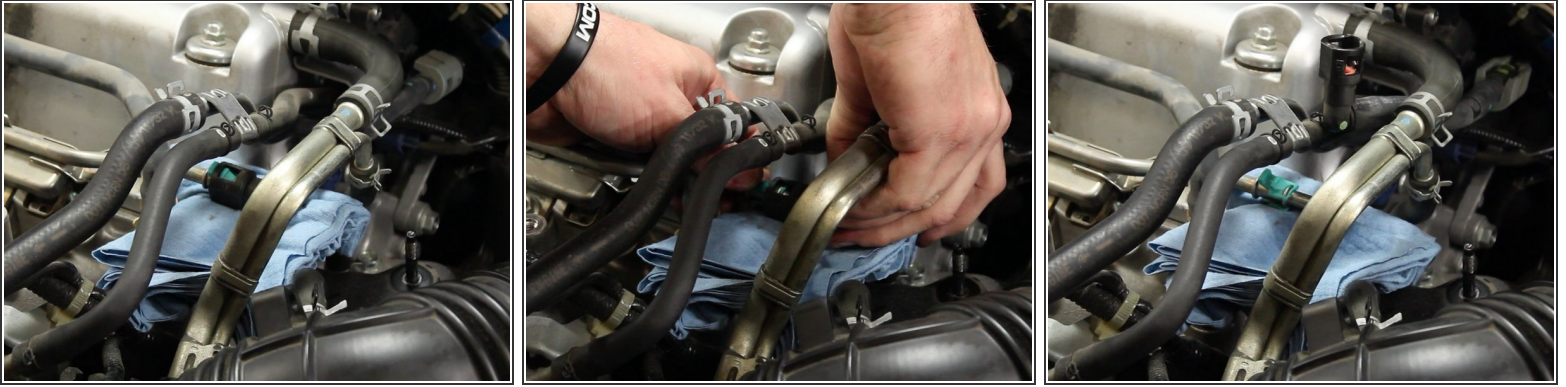

- Disconnect the fuel line from the fuel rail by pressing on the release clips.
- Once the line has been disconnected, turn the fitting upward to prevent more fuel from spilling.

**⚠ If the vehicle has been running within the past hour, the fuel system could still be holding pressure. When disconnecting the line, be sure to have plenty of towels for any fuel spray or spillage.**

## Step 10

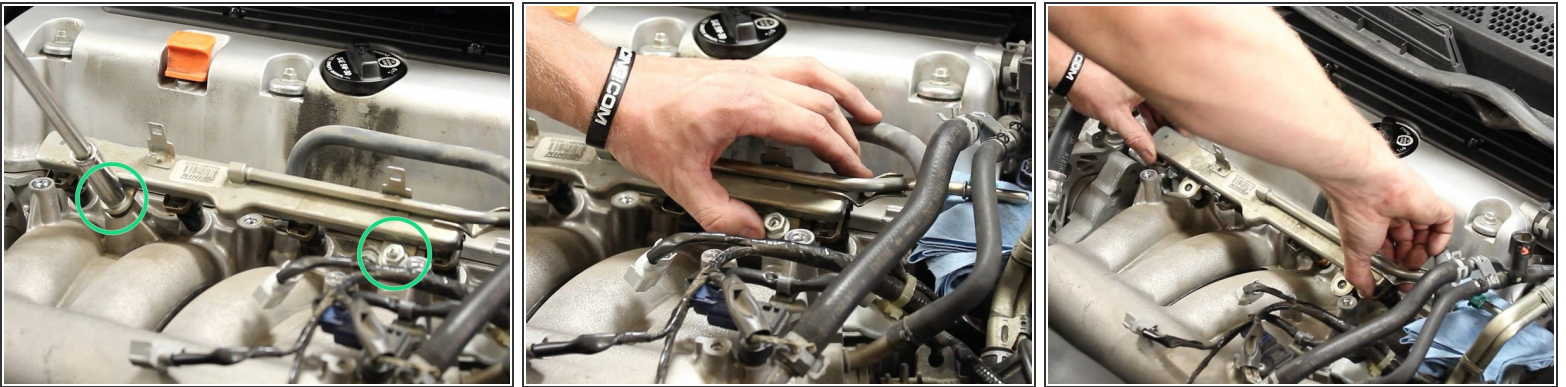

- Remove the 12mm nuts that mount the fuel rail to the intake manifold.
- With both hands, carefully pull away the fuel rail from the manifold to remove.

**⚠ If you do not pull evenly, you could damage the injectors.**

## Step 11



- Remove the quick disconnect locking clip from the factory fuel rail and install on the new fuel rail.
- ⓘ This is only required if you are switching to an aftermarket fuel rail.

## Step 12

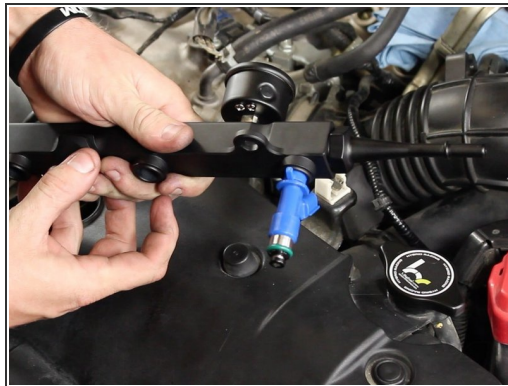

- Insert injectors into the ports of the fuel rail. Make sure the wire harness connection clips are on the opposite side of the fuel rail mounting points.
- ⓘ Fuel or a small amount of oil applied to the o-rings will ease the installation of the injectors into the fuel rail.
- Install the quick disconnect fuel line connection clip.

## Step 13



- Re-install the fuel rail with the new injectors. Evenly push on the fuel rail to insure you evenly seat the injectors into the intake manifold.
- ⓘ Use a small amount of fuel or oil on the injector o-rings to ease in the installation of the injectors into the manifold.
- Re-install the 12mm nuts to tighten down the fuel rail.

## Step 14



- Attach quick disconnect fuel line to the fuel rail.
- Clip the injector clips onto the new injectors.
- ☞ Make sure you have the correct clip going to the matching injector for proper function.
- Re-install the ground wire in the factory location.

## Step 15

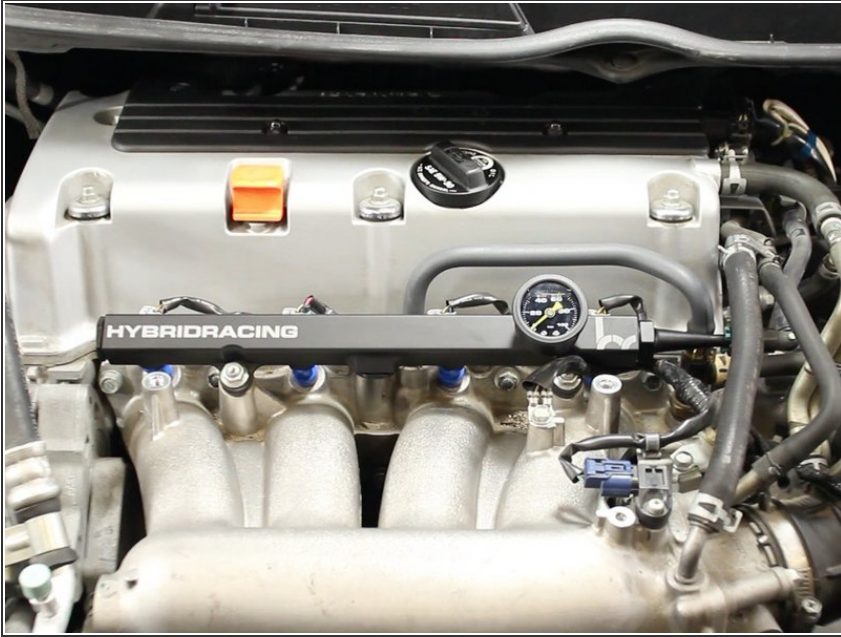

- Insert wisdom here.
- ☑ With the new injectors installed, make sure you have the ECU map adjusted to accommodate the new fuel injectors.
- You have successfully completed the installation!